

Property Location:

Residential Property Record Card - Carbon County, PA

31 Uffleman Lane

Parcel ID: 22A-51-EV1918

Map Block No: 1

Class: R

State Class: 101

Card 1 of 1

Current Owner
Dittbrenner, Steve & Mary 1103-38 Brinton Place Road West Chester PA 19380

Previous Owner History		
Name	Deed	Date
Flesher, Paul R & Gail A	1193/292	12/19/2003
Kennard, Andre L	482/043	

Miscellaneous	
Deed Info:	2236/818-06/17/2016-X
Zoning:	R2
Routing No:	19-10466-0
Neighborhood:	1928
Living Units:	1
Census Trct:	
District:	51

Assessment Information		
Cost Value	Value *	Prior
Land:	7,900	1,332
Building:	97,000	5,270
Total:	104,900	6,602
Assessed Information:		
Land:		2,883
Building:		35,401
Total:		38,284
Effective DOV: 1/1/2000		
Value Flag: COST VALUE		
Manual Override Reason:		

Notes

Entrance Information					
Date	Time	ID	Actv	Entrance Code	Source
07/26/1999		W		Not At Home Entry + Sign Entry + Sign	Other

Sales History				
Book/Page	Date	Price	Type	Validity

Permit Information				
Date	Permit #	Price	Purpose	% Comp.
				0
				0

Land Information				
Type	Size	Grade	Influence Factor 1, 2 and %	Value
Primary	S	20000	0	7,930
Total Acres for this Parcel		0.459	Total Land Value 7,900	

Out Building Information								
Type	Qty	Year	Size1	Size2	Grade	Cond	%Good	Value
	0	0	0	0			0%	0
	0	0	0	0			0%	0
	0	0	0	0			0%	0
	0	0	0	0			0%	0
	0	0	0	0			0%	0
	0	0	0	0			0%	0
	0	0	0	0			0%	0
	0	0	0	0			0%	0
	0	0	0	0			0%	0
	0	0	0	0			0%	0
Total OBY for this card								0



Inspection witness by: _____

Property Location:
31 Uffleman Lane

Residential Property Record Card - Carbon County, PA

Parcel ID: 22A-51-EV1918

Map Block No: 1

Class: R State Class: 101 Card 1 of 1

Dwelling Information	
Style:	Ranch
Condo Style:	
Exterior Walls:	Frame
Story Height:	1.0
Attic:	None
Interior/Exterior:	Same
Basement:	Pier/Slab
Bsmt Garage:	0
Rec Room size:	0 0
FBLA size:	0 0
Unfinished Area:	0
Inlaw Apts:	0
WB Fireplace:	Stacks 1 Openings 1
MTL Fireplace:	Stacks 0 Openings 0
Heating Type:	Basic
Fuel:	Electric
Heating System:	Electric
Year Built:	1987
Eff. Yr Built:	0
GFA/True GFA:	1008 1008
TLA/True TLA:	1008 1008
Basement Area:	0
Grade:	C
Condition:	Good
CDU:	FR
Building Notes:	
Tot	
Rooms:	5
Bedrooms:	3
Full Baths:	1
Half Baths:	1
Add'l Fixtures:	0

Replacement Costs	
Base Price:	65,050
Additions:	3,300
Unfinished Area:	0
Basement:	-9,000
Attic:	0
Plumbing:	1,480
Heating A/C Adj.:	0
FBLA:	0
Rec Room:	0
Fire Place:	3,330
Basement Garage:	0
Exterior Trim:	0
Subtotal:	64,160
Grade Factor:	1.00
C & D Factor:	0.00
Total RCN:	64,160
Percent Good:	0.84
Market Adj.:	1.80
Total RCNLD:	97,000

Addition Information					
Low	1st	2nd	3rd	Area	Points
	31			150	1500
	31			96	900
	31			96	900

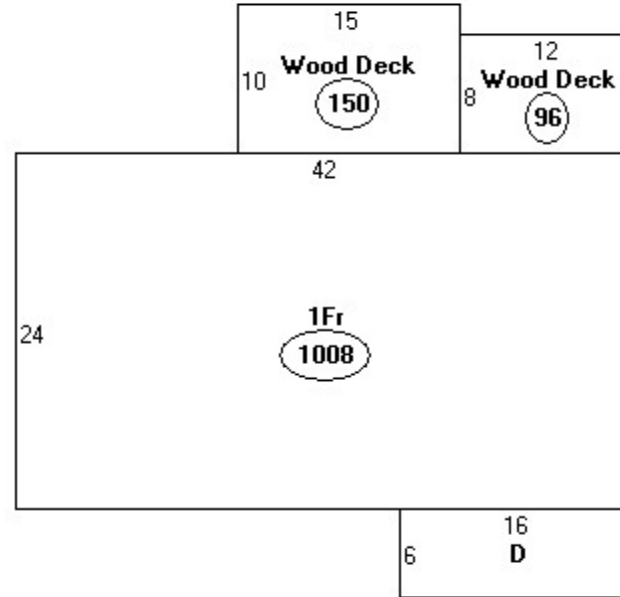

- Descriptor/Area
- A: 1Fr
1008 sqft
 - B: Wood Deck
150 sqft
 - C: Wood Deck
96 sqft
 - D: Wood Deck
96 sqft

Owner/Values: Includes all Land/Buildings/OBYs for this Parcel					
	Current	Cost	Market	Income	Prior
Land:	7,900	7,900	7,900	0	1,332
Building:	97,000	97,000	52,400	0	5,270
Total:	104,900	104,900	60,300	0	6,602